

- NOTES:
1. REFER TO FIRESTONE WEBSITE FOR MOST CURRENT INFORMATION.
 2. INSTALL FIRESTONE TERMINATION BAR WITH 1/4" (6 mm) GAP BETWEEN ADJOINING SECTIONS.
 3. CUT TERMINATION BAR AT INSIDE AND OUTSIDE CORNERS. **DO NOT BEND AROUND CORNERS.**
 4. TERMINATION BAR MUST BE FASTENED WITHIN 1" (25 mm) MAX. OF ALL SECTION ENDS.
 5. APPLY WATERBLOCK IN A 3/8" (10 mm) TO 1/2" (13 mm) BEAD AT APPROXIMATELY 10 L.F. PER TUBE.

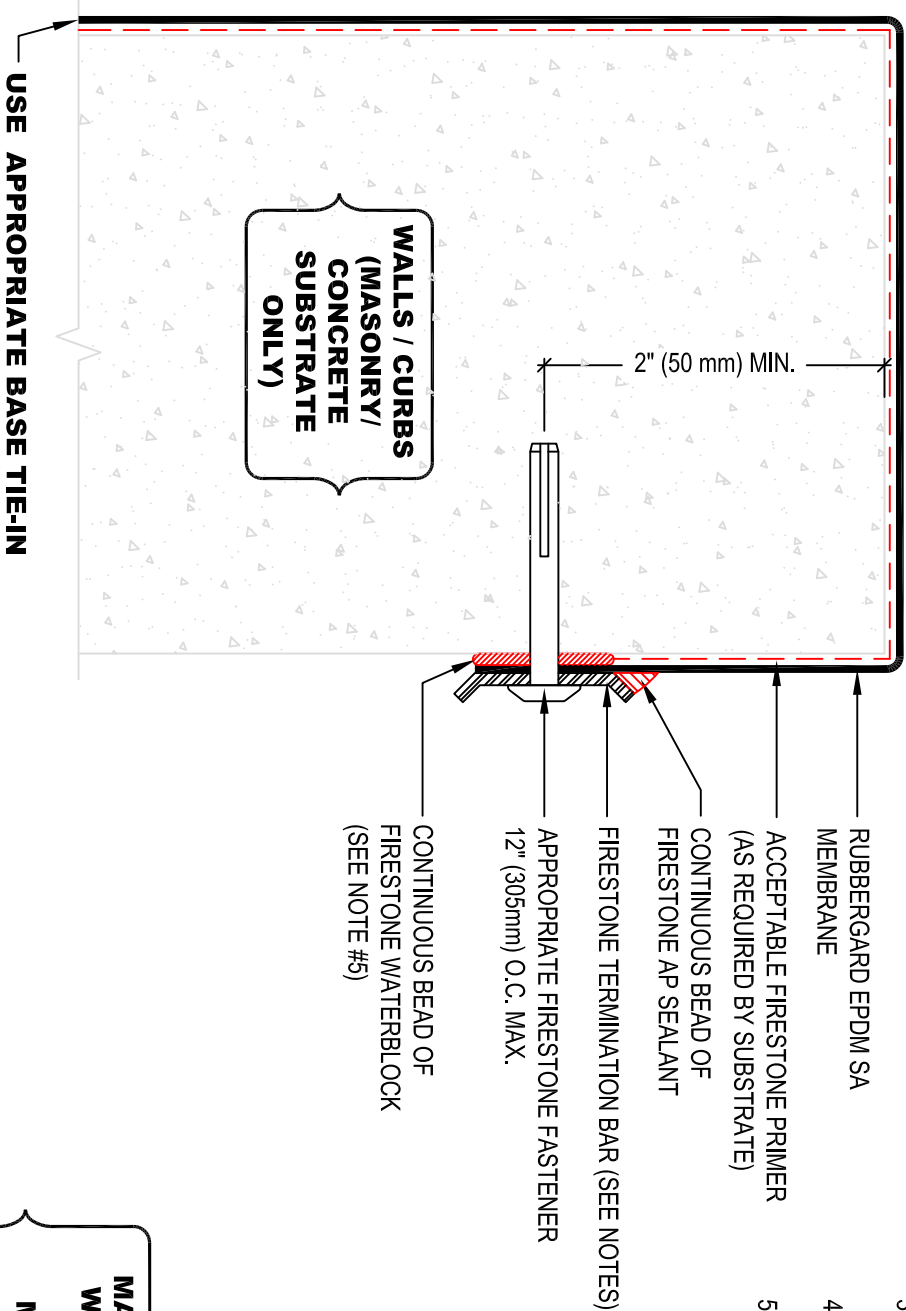

MASONRY AND CONCRETE WALLS / CURBS MUST BE WATERPROOFED AND MAINTAINED IN ORDER FOR ANY SURFACE MOUNTED TERMINATION TO BE EFFECTIVE.

MAXIMUM WARRANTY: 20 YEARS

TERMINATION ON OUTSIDE OF PARAPET WALL WITH TERMINATION BAR
RUBBERGARD™ EPDM SA

ACCEPTABLE SYSTEMS: EPDM SA

ISSUE / REVISION DATE: 8/29/2017
NOT TO SCALE
DETAIL NO. EPDM SA T-2