

NOTES:

1. REFER TO FIRESTONE WEBSITE FOR MOST CURRENT INFORMATION.
2. GROUND WIRE SUPPORTS SHALL BE INSTALLED IN SIMILAR MANNER TO LIGHTNING RODS.
3. A SUFFICIENT NUMBER OF GROUND WIRE SUPPORTS MUST BE INSTALLED TO ASSURE THAT THE GROUND WIRE DOES NOT COME IN CONTACT WITH FIELD OF FLASHING MEMBRANE.
4. IF GROUND WIRE COMES IN CONTACT WITH FIELD OR FLASHING MEMBRANE, INSTALL QUICKSEAM BATTEN COVER UNDER THE GROUND WIRE TO PREVENT CONTACT WITH THE ROOFING MEMBRANE.
5. FIRESTONE ASSUMES NO RESPONSIBILITY FOR ATTACHMENT OF LIGHTNING RODS OR DAMAGE TO THE ROOF SYSTEM DUE TO FAILURE OR DETACHMENT.

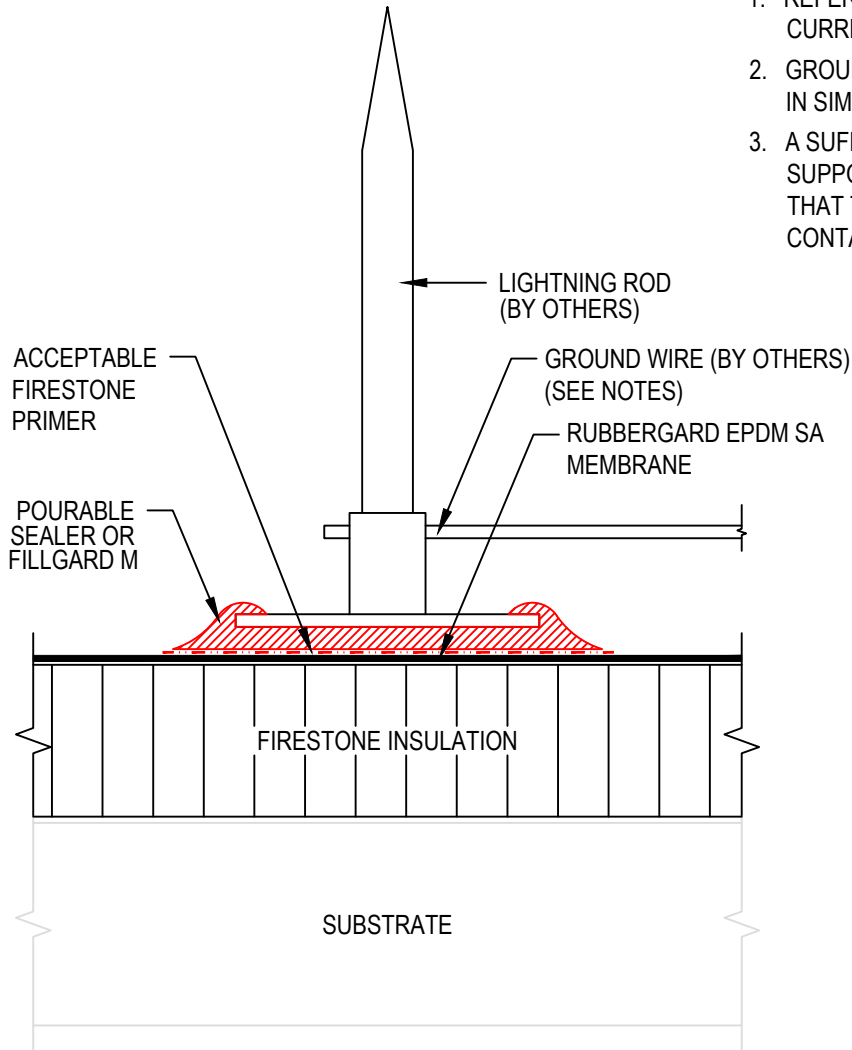

ROOF MOUNT

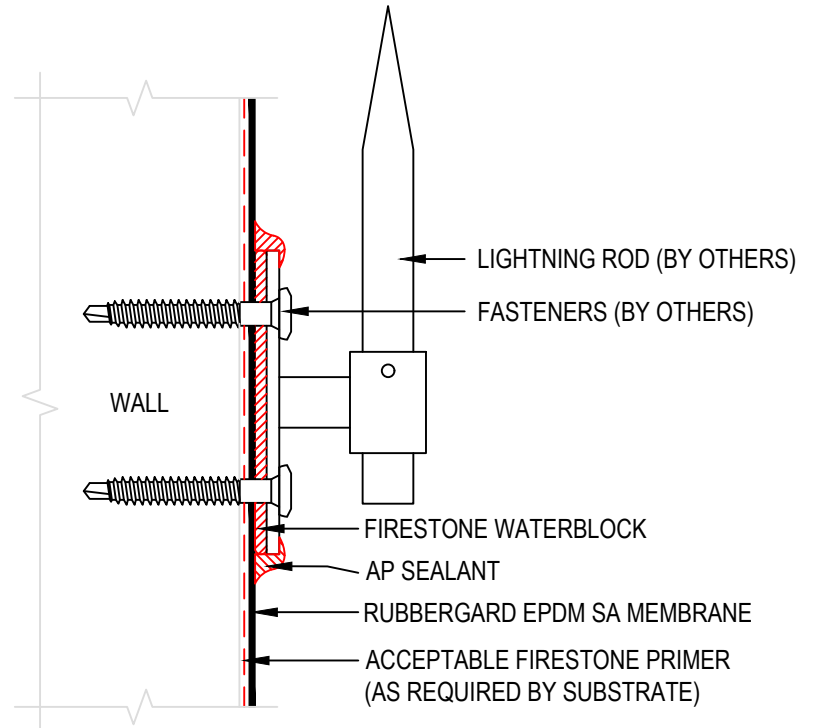

WALL MOUNT

MAXIMUM WARRANTY: **N/A**

Firestone
BUILDING PRODUCTS
NOBODY COVERS YOU BETTER.™
 www.firestonebpco.com

LIGHTNING ROD

RUBBERGARD™ EPDM SA

ACCEPTABLE SYSTEMS: EPDM SA

ISSUE / REVISION
 DATE:
 10/09/2017

NOT TO SCALE

DETAIL NO.
 EPDM SA M-6