

NOTES:

1. REFER TO DETAIL ML-T-7 FOR HIGH WALLS.
2. ATTACHMENT OF THE SHEET METAL IS THE RESPONSIBILITY OF THE SPECIFIER.
3. REGULAR MAINTENANCE OF SHEET METAL AND SEALANTS REQUIRED. NOT INCLUDED AS PART OF THE FIRESTONE WARRANTY.
4. GEOMEMBRANE AND LINER ARE INTERCHANGEABLE TERMS.

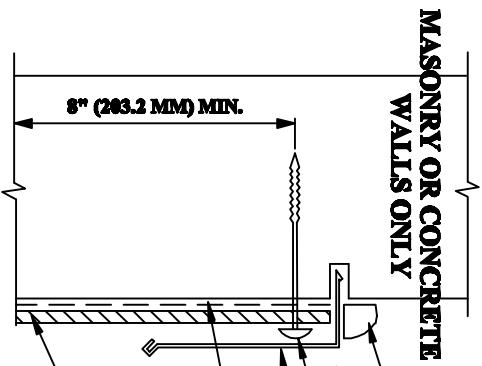

FIRESTONE GENERAL PURPOSE SEALANT OR HIGH GRADE SEALANT BY OTHERS SEE NOTE #3 FASTEN 12" (304.8 MM) O.C. MAX.

SHEET METAL

ADHESIVE

FP-R GEOMEMBRANE EXTENDING 8" (203.2 MM) MIN. FROM SURFACE.

REFER TO A CURRENT SMACNA MANUAL FOR ACCEPTABLE PROFILES

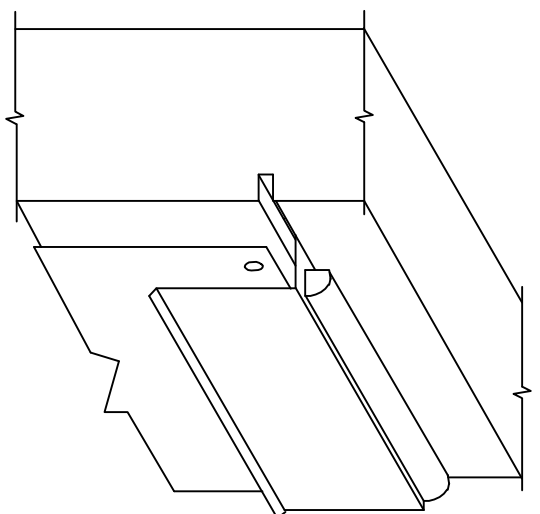

Firestone

20 Geomembranes that Work 09

FP-R Geomembrane
Saw Cut Reglet Counterflashing Termination

Detail No. ML-T-4
Systems Polypropylene