

A.

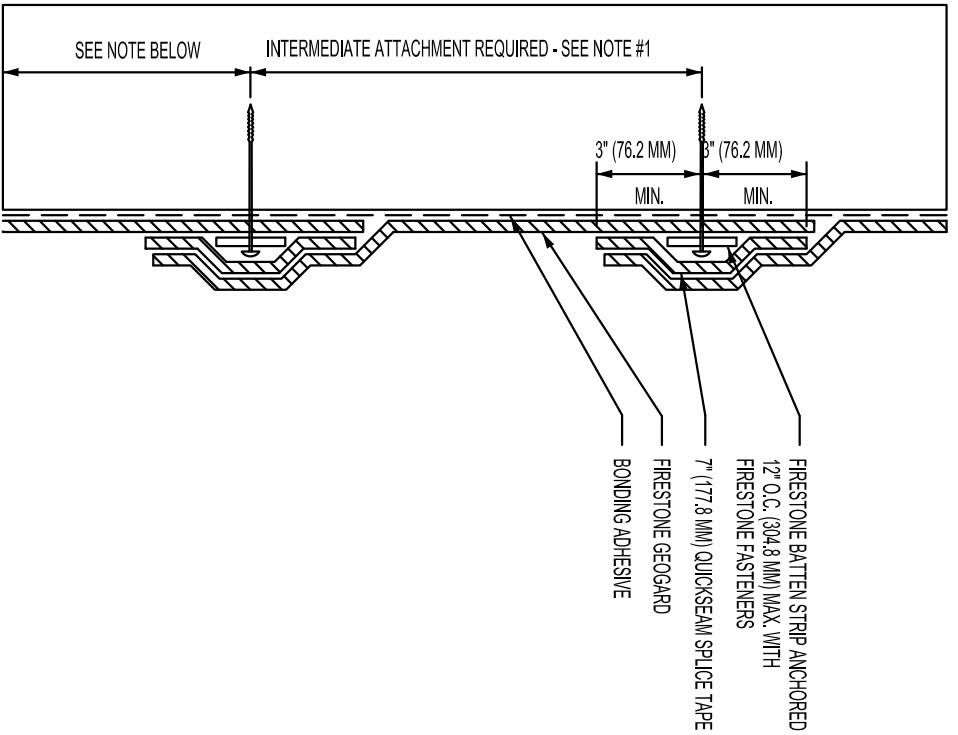

B.

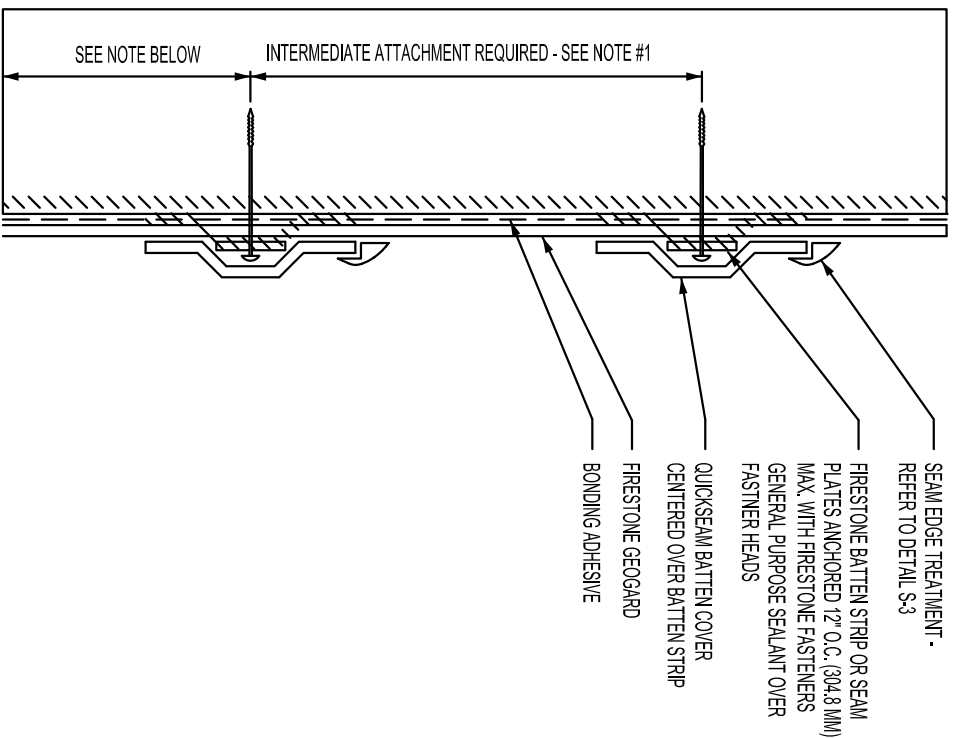

- INTERMEDIATE ATTACHMENTS REQUIRED AS FOLLOWS:
- UP TO 5' (1524 MM) WALL HEIGHT - NONE REQUIRED
  - 5' (1524 MM) - 10' (3048 MM) WALL HEIGHT - ONE ATTACHMENT AT 1/2 THE WALL HEIGHT
  - ABOVE 10' (3048 MM) - ONE ATTACHMENT EVERY 3' (914 MM)

**Intermediate Attachment at Wall Flashing**

GEOGARD™

Living In Action™

ISSUE / REVISION  
DATE:  
7-30-2015

DETAIL NO.  
**T-7**

MAXIMUM WARRANTY: **N/A**

ACCEPTABLE SYSTEMS:  
EPDM, EPDM-R, ECOWHITE EPDM

NOT TO SCALE

**T-7**