

MASONRY AND CONCRETE WALLS MUST BE WATERPROOFED AND MAINTAINED IN ORDER FOR ANY SURFACE MOUNTED TERMINATION TO BE EFFECTIVE.

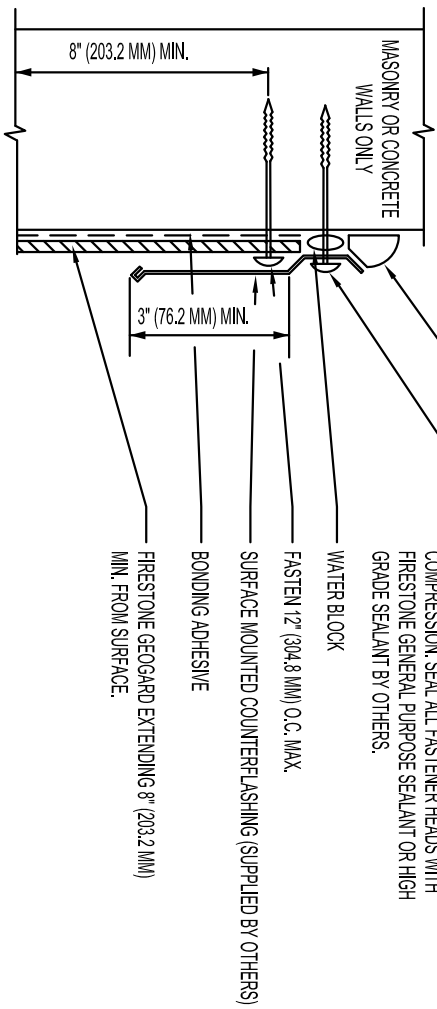

- FIRESTONE GENERAL PURPOSE SEALANT OR HIGH GRADE SEALANT BY OTHERS
- ATTACH COUNTERFLASHING 12" (304.8 MM) O.C. MAX. OR AS REQUIRED TO PROVIDE CONTINUOUS COMPRESSION SEAL ALL FASTENER HEADS WITH FIRESTONE GENERAL PURPOSE SEALANT OR HIGH GRADE SEALANT BY OTHERS.
- WATER BLOCK
- FASTEN 12" (304.8 MM) O.C. MAX.
- SURFACE MOUNTED COUNTERFLASHING (SUPPLIED BY OTHERS)
- BONDING ADHESIVE
- FIRESTONE GEOGARD EXTENDING 8" (203.2 MM) MIN. FROM SURFACE.

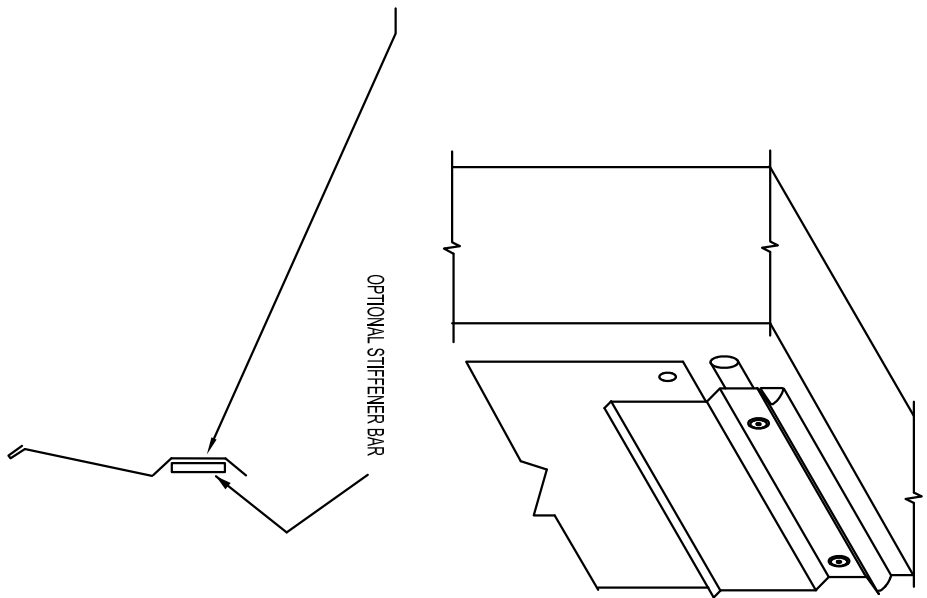

- NOTES:
1. REFER TO DETAIL T-7 FOR HIGH WALL FLASHINGS.
 2. ATTACHMENT OF THE COUNTERFLASHING IS THE RESPONSIBILITY OF THE SPECIFIER.
 3. REGULAR MAINTENANCE OF COUNTERFLASHING AND SEALANTS REQUIRED. NOT INCLUDED AS PART OF THE FIRESTONE WARRANTY.

MAXIMUM WARRANTY: **N/A**

Surface Mounted Counter-Flashing Termination

GEOGARD™

ACCEPTABLE SYSTEMS:
EPDM, EPDM-R, ECOWHITE EPDM

ISSUE / REVISION
DATE:
7-30-2015

NOT TO SCALE

DETAIL NO.
T-5

