

- NOTES:
1. REFER TO DETAIL T-7 FOR HIGH WALL FLASHINGS.
  2. ATTACHMENT OF THE COUNTERFLASHING IS THE RESPONSIBILITY OF THE SPECIFIER.
  3. REGULAR MAINTENANCE OF COUNTERFLASHING AND SEALANTS REQUIRED. NOT INCLUDED AS PART OF THE FIRESTONE WARRANTY.

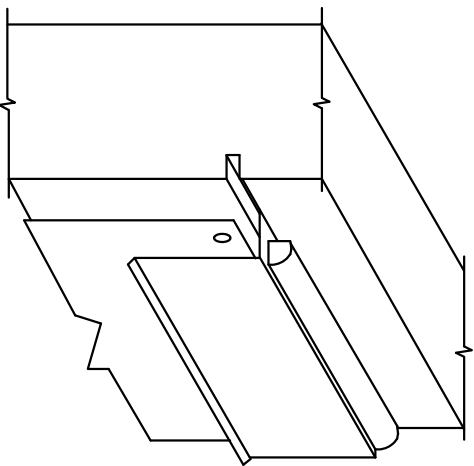
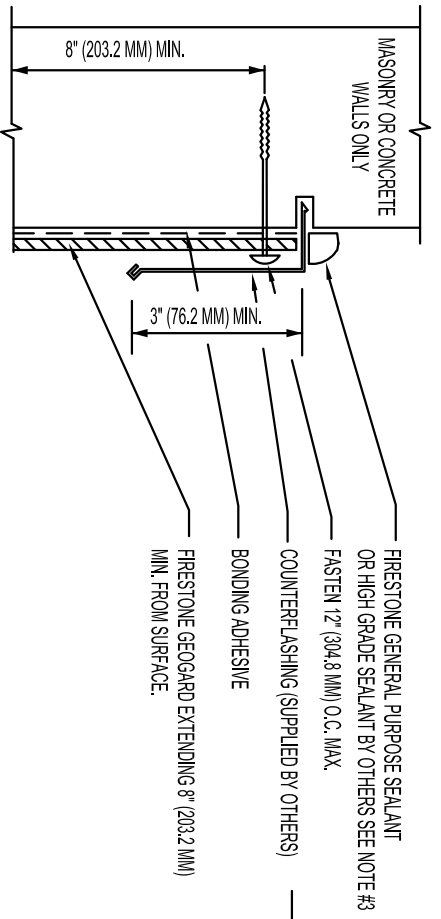

REFER TO A CURRENT SIMACNA  
MANUAL FOR ACCEPTABLE PROFILES

MAXIMUM WARRANTY: **N/A**

**Saw Cut Reglet Counter-Flashing Termination**

GEOGARD™  
ACCEPTABLE SYSTEMS:  
EPDM, EPDM-R, ECOWHITE EPDM

ISSUE / REVISION  
DATE:  
7-30-2015  
NOT TO SCALE

DETAIL NO.  
**T-4**

