

**UNDER NO CIRCUMSTANCES CAN THE PIPE PENETRATE OR COME WITHIN 4" (101.6 mm) OF THE PANEL SEAM.**

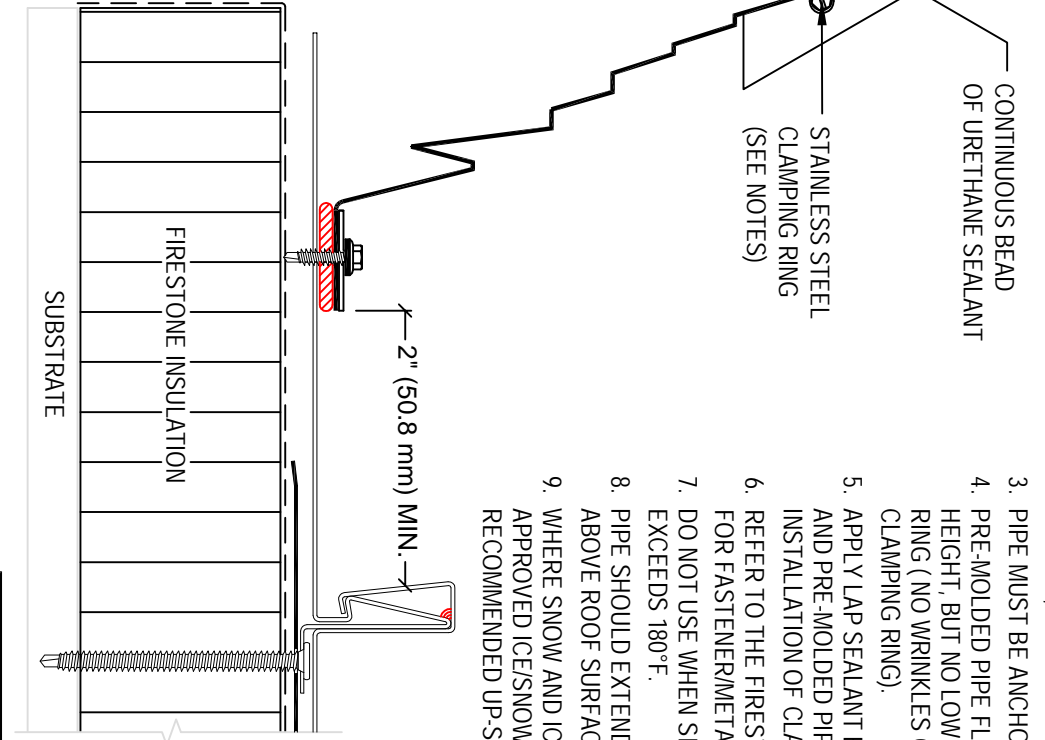
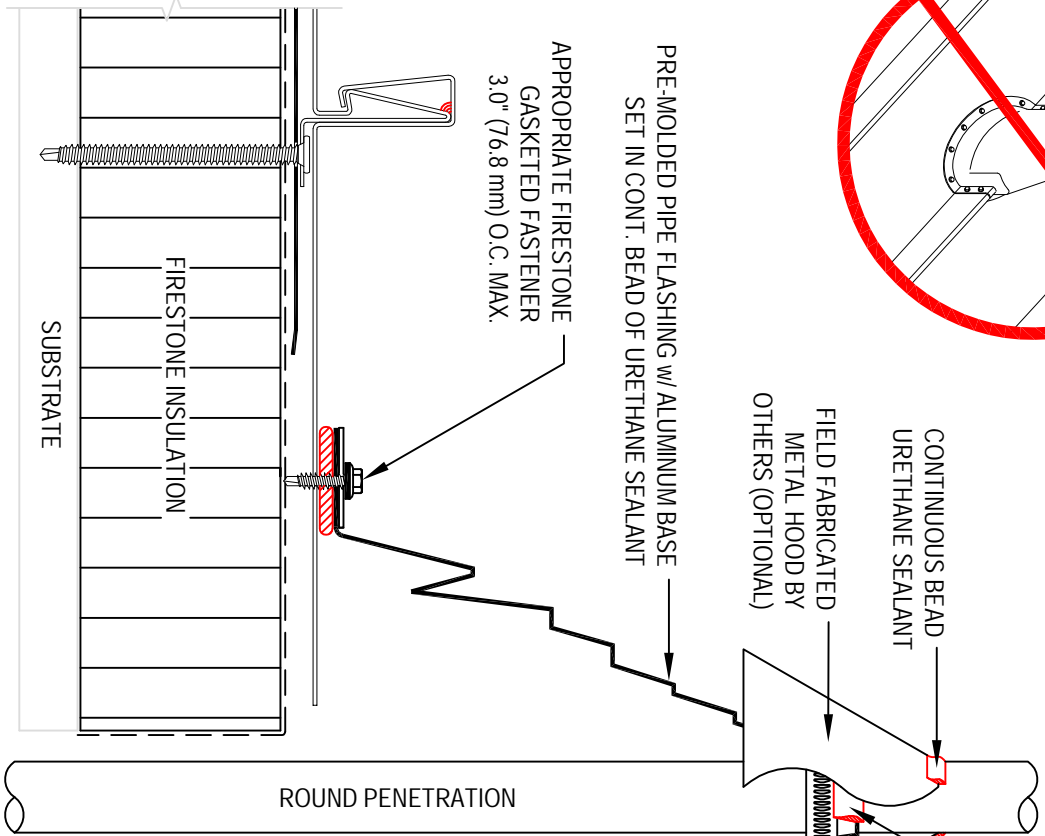

- NOTES:
1. REFER TO FIRESTONE WEBSITE FOR MOST CURRENT INFORMATION.
  2. REMOVE ALL EXISTING FLASHINGS, LEADS, ETC. PIPE SURFACE MUST BE FREE OF ALL RUST, GREASE, INSULATION, ETC.
  3. PIPE MUST BE ANCHORED TO ENSURE STABILITY.
  4. PRE-MOLDED PIPE FLASHING MAY BE CUT TO HEIGHT, BUT NO LOWER THAN REINFORCING RING (NO WRINKLES OR FOLDS UNDER CLAMPING RING).
  5. APPLY LAP SEALANT BETWEEN PENETRATION AND PRE-MOLDED PIPE FLASHING PRIOR TO INSTALLATION OF CLAMPING RING.
  6. REFER TO THE FIRESTONE TECHNICAL DATABASE FOR FASTENER/METAL COMPATIBILITY.
  7. DO NOT USE WHEN SERVICE LINE TEMP. EXCEEDS 180°F.
  8. PIPE SHOULD EXTEND A MINIMUM OF 8" (203.2 mm) ABOVE ROOF SURFACE.
  9. WHERE SNOW AND ICE ARE COMMON, FIRESTONE APPROVED ICE/SNOW-DAM PROTECTION IS RECOMMENDED UP-SLOPE OF PENETRATIONS

**MAXIMUM WARRANTY: 20 YEARS**

**Firestone**  
BUILDING PRODUCTS  
NOBODY COVERS YOU BETTER.™  
www.firestonebpc.com

**PENETRATION WITH PIPE FLASHING**  
**UNA-CLAD®**  
ACCEPTABLE SYSTEMS: UC-4 RS

ISSUE / REVISION  
DATE:  
04/18/2017

DETAIL NO.  
**4-P-1**

NOT TO SCALE