

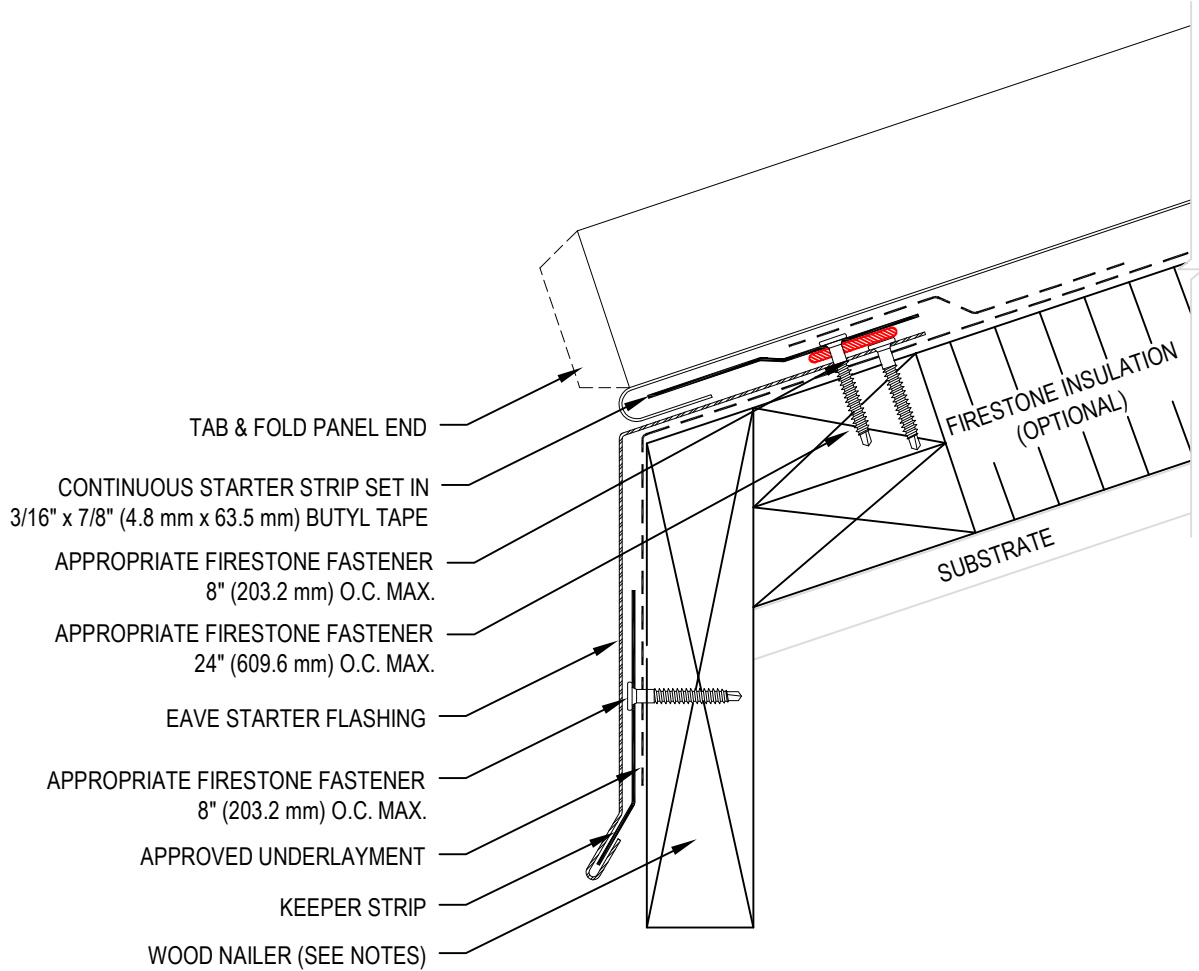

NOTES:

1. REFER TO FIRESTONE WEBSITE FOR MOST CURRENT INFORMATION.
2. REFER TO TECHNICAL INFORMATION SHEETS FOR FASCIA SIZES, ACCESSORIES, AND FINISHES AVAILABLE.
3. WOOD NAILER MUST BE INSTALLED TO MEET APPLICABLE BUILDING CODES OR 200 LBS PER LINEAR FOOT MINIMUM IN ANY GIVEN DIRECTION.
4. REFER TO THE FIRESTONE TECHNICAL DATABASE FOR FASTENER COMPATIBILITY WITH METAL.
5. REFER TO THE FIRESTONE TECHNICAL DATABASE FOR HEM LENGTH AND REQUIRED DISTANCE BETWEEN THE PANEL AND CLEAT.
6. APPLICATION DETAILS ARE FOR ILLUSTRATION PURPOSES ONLY AND MAY NOT BE APPROPRIATE FOR ALL BUILDING DESIGNS AND CONDITIONS.



MAXIMUM WARRANTY: **20 YEARS**

 <p>Firestone BUILDING PRODUCTS NOBODY COVERS YOU BETTER.™ www.firestonebpco.com</p>	CLEATED SLIDING EAVE AT DRIP EDGE		ISSUE / REVISION DATE: 8/15/2008	DETAIL NO. 14-E-3
	UNA-GLAD®	ACCEPTABLE SYSTEMS: UC14-RS	NOT TO SCALE	