

- NOTES:
1. REFER TO FIRESTONE WEBSITE FOR MOST CURRENT INFORMATION.
 2. THIS DETAIL SHOULD BE USED ONLY WHERE THE DECK IS SUPPORTED BY THE OUTSIDE WALL.
 3. WOOD NAILERS MUST BE INSTALLED WITH SUITABLE FASTENERS TO MEET APPLICABLE BUILDING CODES (200 LBS PER LINEAR FOOT MIN IN ANY GIVEN DIRECTION).
 4. ALL SHEET METAL IS TO BE INSTALLED PER SMACNA GUIDELINES.
 5. PRIME METAL BEFORE ADHERING FLASHING.
 6. GRANULES MUST BE EMBEDDED WHEN THERMALLY FUSING GRANULE SURFACED CAP SHEET.

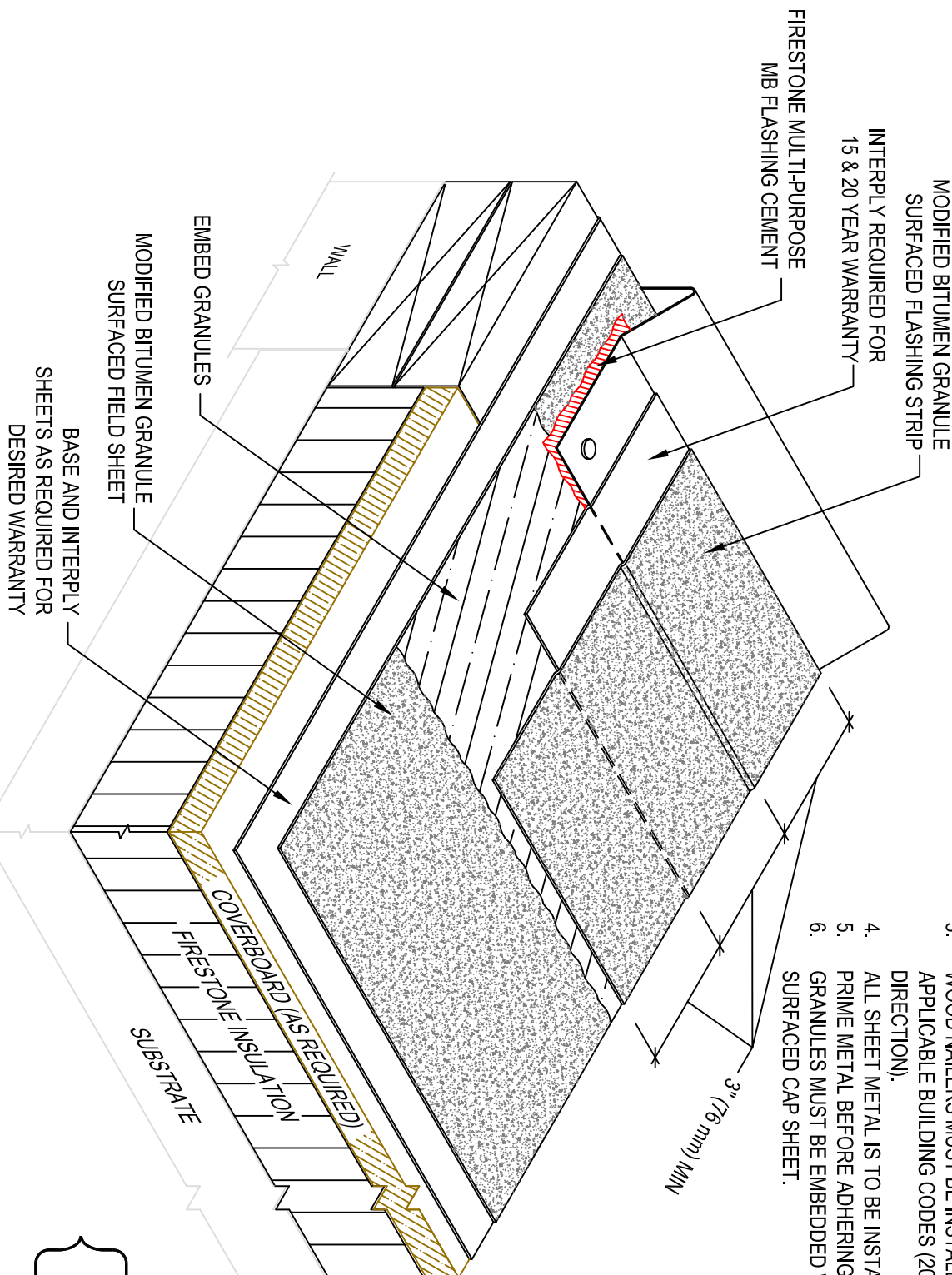

MAXIMUM WARRANTY: **20 YEARS**

DETAIL APPLIES TO APP & SBS MEMBRANES