

- NOTES:
1. REFER TO FIRESTONE WEBSITE FOR MOST CURRENT INFORMATION.
 2. THIS DETAIL SHOULD BE USED ONLY WHERE THE DECK IS SUPPORTED BY THE OUTSIDE WALL.
 3. WOOD MALERS MUST BE INSTALLED WITH SUITABLE FASTENERS TO MEET APPLICABLE BUILDING CODES (200 LBS PER LINEAR FOOT MIN IN ANY GIVEN DIRECTION).
 4. ALL ANCHORGARD SHEET METAL IS TO BE INSTALLED PER FIRESTONE INSTRUCTIONS.
 5. GRANULES MUST BE EMBEDDED WHEN THERMALLY FUSING GRANULE SURFACED CAP SHEET.

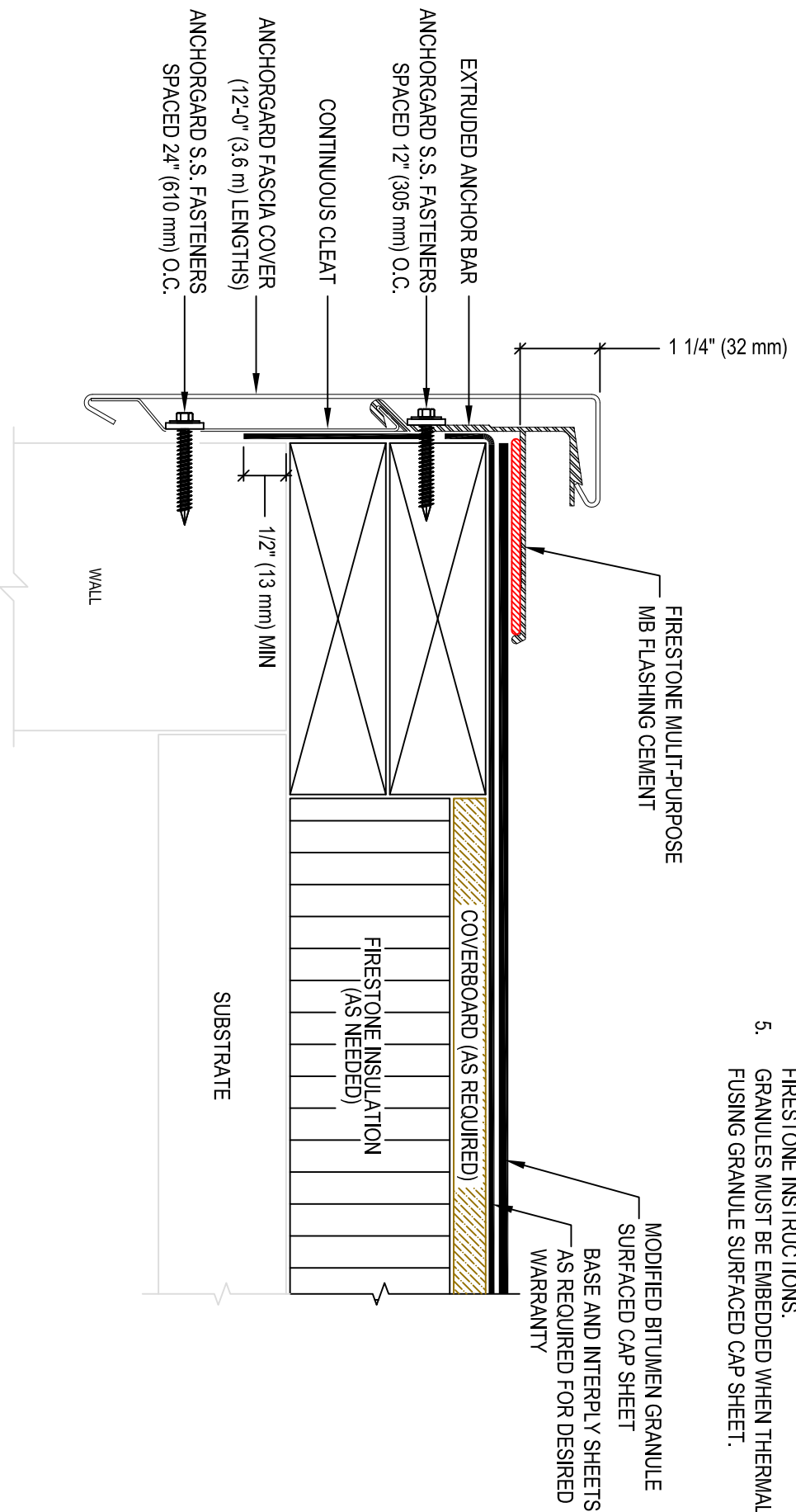

MAXIMUM WARRANTY: **20 YEARS**

ANCHORGARD EXTENDED FACE ROOF EDGE

ASPHALT SYSTEMS

ACCEPTABLE SYSTEMS: MODIFIED BITUMEN

ISSUE/REVISION
DATE:

7/02/2014

NOT TO SCALE

DETAIL NO.

MB-RE-8