

INSULATION ATTACHMENT OPTIONS:

- INSULATION MAY BE ADHERED AS FOLLOWS:
 - FIRESTONE I.S.O. TWIN PACK INSULATION ADHESIVE, FIRESTONE I.S.O. FIX II INSULATION ADHESIVE, OR FIRESTONE I.S.O. STICK INSULATION ADHESIVE MAY BE USED WITH A BEAD SPACING OF 12" (305 MM) IN THE FIELD, 6" (152 MM) IN THE PERIMETERS, AND 4" (102 MM) IN THE CORNERS.
 - IF FIRESTONE I.S.O. SPRAY S INSULATION ADHESIVE IS USED, IT MUST BE SPACED 4" (102 MM) THROUGHOUT.
 - MAXIMUM BOARD SIZE IS 4' X 4' (1.2 X 1.2 M) WHEN ADHESIVE IS USED.
- INSULATION MAY BE MECHANICALLY FASTENED WITH FIRESTONE HD FASTENERS OR FIRESTONE CONCRETE DRIVE FASTENERS (AS APPROPRIATE) AT A MINIMUM RATE OF 16 PER 4' X 8' (1.2 X 2.4 M) BOARD.

NOTES:

- REFER TO FIRESTONE WEBSITE FOR MOST CURRENT INFORMATION.
- REFER TO INSULATION ATTACHMENT OPTIONS TO THE LEFT.
- ALL FIELD FLASHING ELEMENTS (PIPES, CURBS, DRAINS, ETC.) MUST BE FLASHED WITH ULTRAFASH LIQUID FLASHING.
- WALL FLASHINGS MAY BE CONSTRUCTED WITH ULTRAFASH LIQUID FLASHING, OR 1 PLY OF SBS PREMIUM BASE AND 1 PLY OF SBS PREMIUM FR ULTRAWHITE CAP SHEET SET IN FIRESTONE MB FLASHING CEMENT.
- ULTRAFASH ONE-PART LIQUID FLASHING IS NOT ELIGIBLE FOR PLATINUM WARRANTIES (30 YRS.).

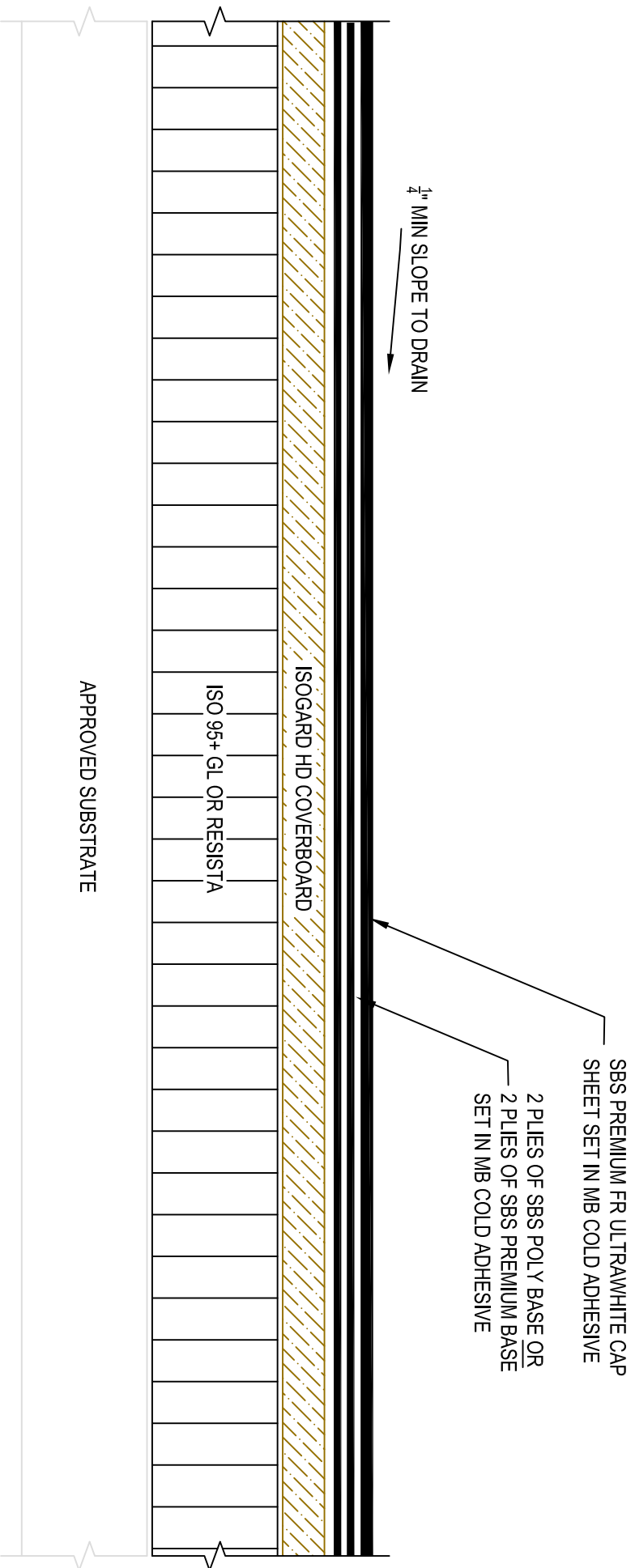

Firestone
 BUILDING PRODUCTS
NOBODY COVERS YOU BETTER.™
 www.firestonebpc.com

COLD ADHESIVE PLATINUM WARRANTY CROSS-SECTION
 ASPHALT SYSTEMS
 ACCEPTABLE SYSTEMS: SBS MOD BIT

ISSUE/REVISION
 DATE: 3/05/2016
 NOT TO SCALE

DETAIL NO.
MB-M-8P

MAXIMUM WARRANTY: 30 YEARS